

This Scale Contains 5 1/2 Miles or 1920 rods the Greater division
 Contains 160 rods the Smaller division Contains 16 rods



This Scale Contains 5 1/2 Miles or 1920 rods the greater division
 Contains 160 rods the Smaller division contains 16 rods

th mo A Draft of Malborough Plantation
 15:3:1667 By Samuel Andrews

The Contents is 29419 Acres

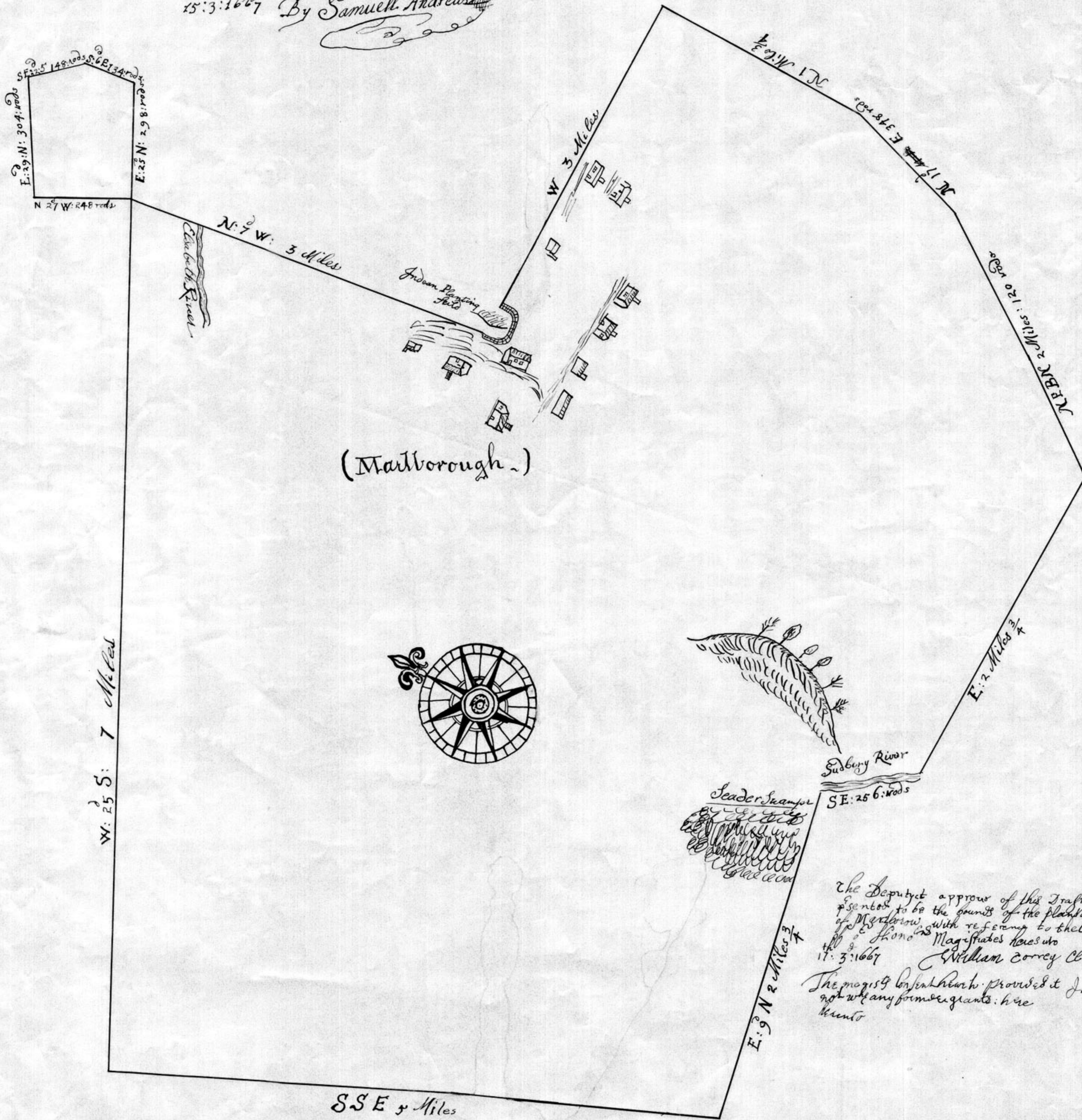

The Deputy approve of this Draft
 present to be the bounds of the plantation
 of Malborough with reference to the Court
 of the Hon^{ble} Magistrates hereunto
 15:3:1667
 William Correy Clerk

The magist^{rs} before which provided it Interfer
 not wth any former grants: here
 unto